

ZONING

(RURAL INDUSTRIAL PARK)

REGIONAL ROAD No. 41

M1	M2	M3
9.2.1	9.2.2	9.2.3

RURAL INDUSTRIAL PARK ONE - MP1

a) Permitted Uses:

- Bakery
- Bank
- Building Supply Outlet
- Custom Workshop
- Day Nursery
- Dry Cleaning and Laundry Establishment
- Eating Establishment
- Equipment Rental Establishment - Domestic
- Machine, Metal and Woodworking Shops
- Public Utility Establishment
- Publishing or Printing Establishment
- Veterinary Establishment
- Warehouse
- Uses accessory to any of the foregoing

b) Zone Requirements:

Lot Area (minimum)	3000.0 m ²
Lot Frontage (minimum)	15.0 m
Yard Requirements (minimum)	
Front Yard	15.0 m
Side Yard	
(a) External Side Yard	10.0 m
(b) In any other case	8.0 m
Rear Yard	15.0 m
Coverage	20%
Building Height (maximum)	
Main Building	15.0 m
Accessory Building	6.0 m

c) No hard surface, structure or parking shall be established within 5.0 m of a septic field.

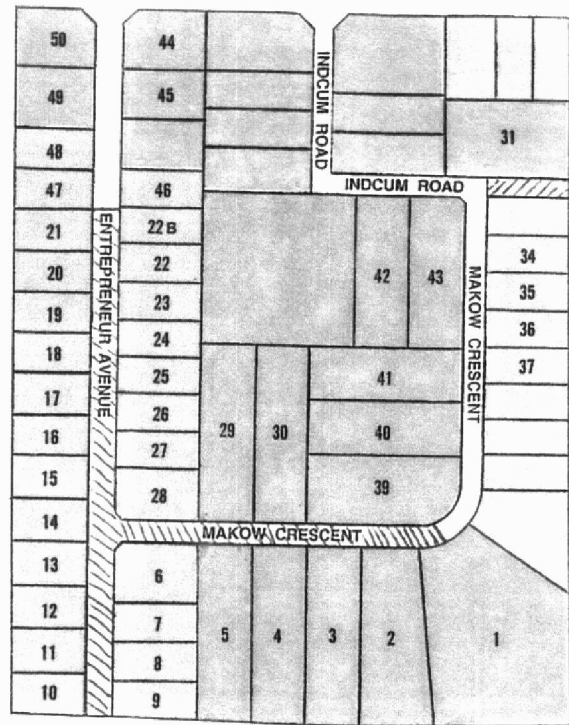

BYLAW No. 54-85

RURAL INDUSTRIAL PARK TWO - MP2

a) Permitted Uses:

In addition to the uses permitted in the MP1 zone, the following uses are permitted:

- Auctioneers Establishment
- Agricultural Implements Sales and/or Service
- Auto Body Shop
- Automotive Trade
- Equipment Rental Establishment - Industrial
- Gasoline Bar
- Landscape Contracting
- Public Garage
- Recreation Vehicle Sales and Storage
- Transport Terminal
- Uses Accessory to any of the foregoing

b) Zone Requirements:

Lot Area (minimum)	3000.0 m ²
Lot Frontage (minimum)	15.0 m
Yard Requirements (minimum)	
Front Yard	15.0 m
Side Yard	
a) External Side Yard	12.0 m
b) In Any Other Case	10.0 m
Rear Yard	15.0 m
Coverage (maximum)	20%
Building Height (maximum)	
Main Building	15.0 m
Accessory Building	6.0 m

c) No hard surface, structure or parking area shall be established within 5.0 m of a septic field.

REGIONAL ROAD No. 41

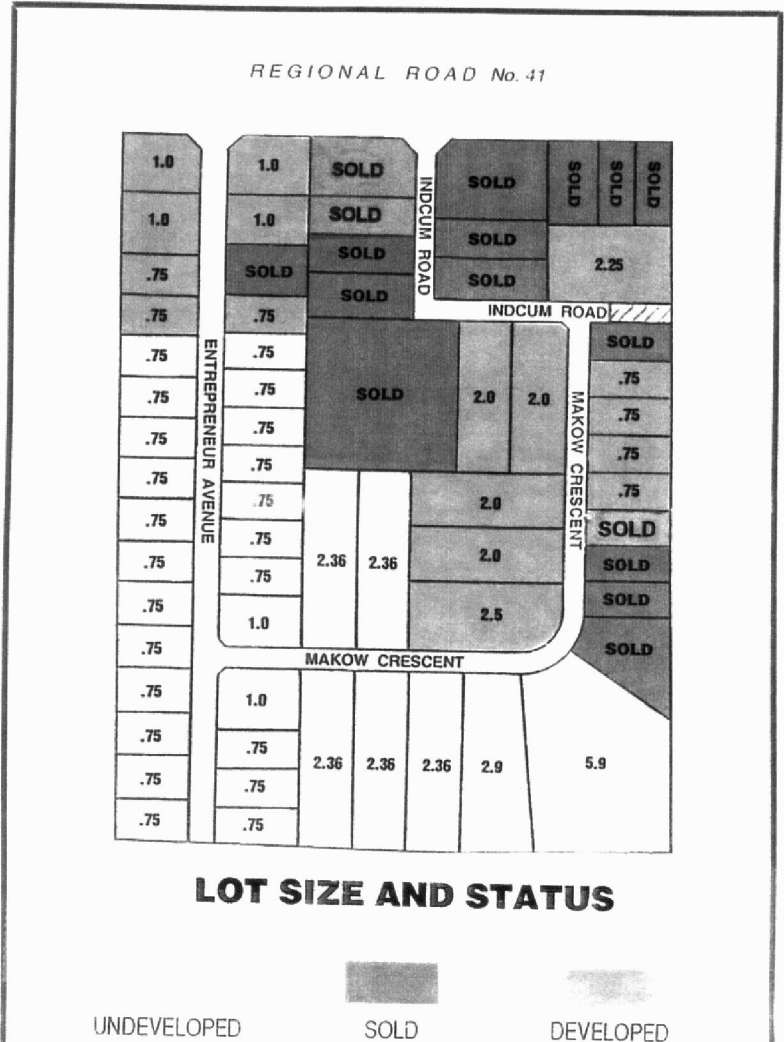

RURAL INDUSTRIAL PARK THREE - MP3

a) Permitted Uses:

In addition to the uses permitted in the MP2 zone, the following uses are permitted:

- Brick Making Plant
- Bulk Storage Production and Sale of Farm Products
- Cement Plant
- Compressed Gas Sales and Service
- Fuel Storage Facility
- Laboratories and Experimental Facilities
- Livestock Sales Outlet
- Lumber Outlet
- Manufacturing Industry
- Salvage Yard or Scrap Yard

b) Zone Requirements:

Lot Area (minimum)	8000.0 m ²
Lot Frontage (minimum)	54.0 m
Yard Requirements (minimum)	
Front Yard	15.0 m
Side Yard	
a) External Side Yard	15.0 m
b) In Any Other Case	10.0 m
Rear Yard	15.0 m
Coverage (maximum)	15%
Building Height (maximum)	
Main Building	15.0 m
Accessory Building	6.0 m

c) No hard surface, structure or parking area shall

UNDEVELOPED

SOLD

DEVELOPED